



HDZ

1080p60 ZOOM CAMERA

3G-SDI + NTSC/PAL | OPTICAL ZOOM | WATERPROOF

Designed especially for exterior airborne operation, HDZ is versatile, easy to use, and of course, it's *Rugged*.

- Plug-and-play with most MFD / EFIS displays
- IP68 waterproof
- Dual outputs: 1080p60 3G-SDI + RS-170 NTSC/PAL
- Optical zoom lens + clean digital zoom
- MIL-STD-704 power input protection
- Digital control panel
- Versatile mounting system

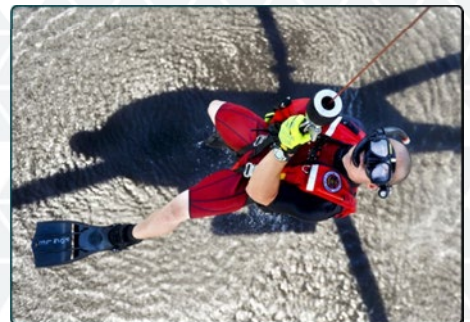

SPECIFICATIONS

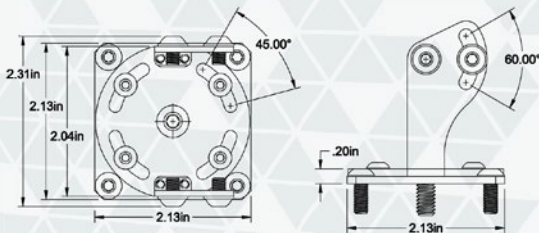
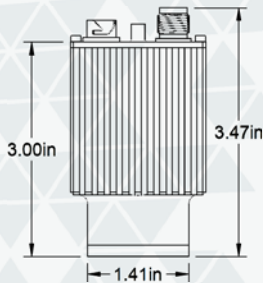
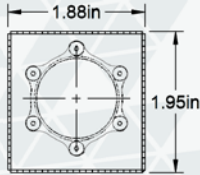

VIDEO

VIDEO OUTPUTS	1x 3G-SDI (SMPTE 424M) / HD-SDI (SMPTE 292M) 1x RS-170 960H Composite NTSC/PAL
IMAGE RESOLUTION / FRAME RATE	configurable up to 1080p60
SENSOR	Sony Starvis IMX327 CMOS
MIN. ILLUMINATION	0.01lux (color), 0.005 lux (B&W)
SHUTTER SPEED	1/30 - 1/50,000 auto / manual
MENU FEATURES	digital zoom, Digital Image Stabilization, WDR, white balance, backlight, sens-up, AGC, day/night modes, 2DNR, 3DNR, flip, rotate, mirror, reticle, text overlay (fixed), defog, ACE, masking, + more
LENS	2.7mm to 12mm F1:1.3 IR optical zoom + one-shot autofocus
FIELD OF VIEW (FOV)	94.1° (wide) to 38° (telephoto) optical zoom + 16x DZoom
COMPATIBILITY	MFD/EFIS displays, SDI and NTSC/PAL, iPad (w/USB accessory)

CONTROL

OSD MENU & ZOOM	joystick-on-cable controller for OSD menu & zoom (standard eqpt.)
ZOOM & FOCUS	digital control panel for zoom / focus / d. zoom
DIGITAL INTERFACE	RS-485 control API for custom applications

ELECTRICAL

POWER	12-32VDC universal input, 1.8watts max
PROTECTION	Meets MIL-STD-704: reverse polarity, ESD, overvoltage, overcurrent, hot swap, surge ride-thru, surge up to 1mS @ 250V
CONNECTORS	video: 2x TNC power/control: Hirose LF07WBR-6P

GENERAL

OPERATING TEMP	-40 to +75C
DIMENSIONS	47.8mm x 49.5mm x 88mm (incl. connectors)
WEIGHT	5 oz
ENCLOSURE	machined, anodized 6061-T6 aluminum
IP RATING	IP68 waterproof
FOG-PROOFING	optional fog-free inert gas purge & backfill (Argon)
BASE PART NOS.	RV-10258A, bracket RV-10259A(-7), controller RV-10270A(-##)

MOUNTING

MOUNTING THREADS	(2x) 1/4" -20 machine threads (4x) 10-32 machine threads
FLAT SURFACES BRACKET	2-axis adjustable bracket (60° pitch, 45° yaw)
CONTOURED SURFACE BRACKET	fits tubing & contoured surfaces

DIGITAL CONTROLLER

POWER	12-32VDC, 1.8watts max
CONNECTORS	2x Hirose LF07WBR-6P connectors w/power pass-thru to camera
ENCLOSURE OPTIONS	MS25212 DZUS rail-mount, flush faceplate, connectors on rear or side
INTERFACE	NVIS-friendly backlit pushbuttons
FUNCTIONS	zoom+, zoom-, focus near, focus far, one-shot refocus, digital zoom (8 levels), custom functions available
OTHER CONTROLLER STYLES	digital zoom-only, camera + DVR control, dry contact control

Rugged Video, LLC
W66N205 Commerce Ct
Cedarburg, WI 53012 USA

Phone: 262-208-8782
E-mail: sales@ruggedvid.com
Web: www.ruggedvid.com

RUGGED
VIDEO